



DONGHUI Motor

DC Planetary Gear Motor

DPG45-775

减速比 REDUCTION RATION	L (mm)	减速比 REDUCTION RATION	L (mm)
1/4	33.6	1/139~1/516	67.5
1/10~1/19	44.9	1/699~1/2672	78.8
1/32~1/100	56.2		

外形尺寸/Dimensions

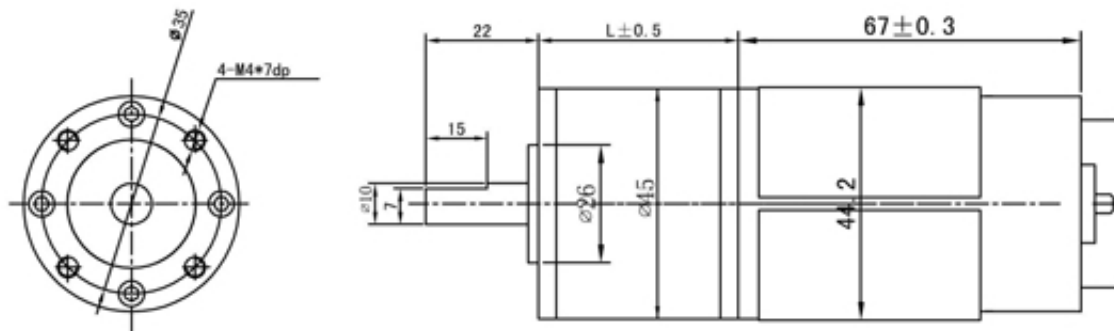

UNIT:MM

直流减速机参数/DC speed reducer parameters

电压 VOLTAGE	减速比 REDUCTION RATIO	1/4	1/10	1/14	1/19	1/32	1/51	1/71	1/100	1/139	1/188	1/264	1/369	1/516	1/699	1/977	1/1367		
12	额定扭力 (kg-cm) RATED TORQUE	1.5	3.5	4.9	6.6	10	16	22	28	39	53	74	104	123	197	276	328		
	额定转速 (rpm) RATED SPEED	927	371	265	195	115	72	52	37	26	19	14	10	7	5	4	2		
	瞬间容许扭力 (kg-cm) MAX MOMENTARY TOLERANCE TORQUE	8	19	27	37	57	91	126	159	221	300	360	360	360	360	360	360		
	空载转速 (rpm) NO LOAD CURRENT	1125	450	321	236	140	88	36	45	32	23	17	12	8	6	5	3		
24	额定扭力 (kg-cm) RATED TORQUE	1.1	2.6	3.7	5	7	12	18	21	29	40	56	79	93	150	209	248		
	额定转速 (rpm) RATED SPEED	647	259	185	136	80	50	36	25	18	13	9	7	5	3	2	1		
	瞬间容许扭力 (kg-cm) MAX MOMENTARY TOLERANCE TORQUE	6	14	20	28	43	69	96	120	168	227	319	360	360	360	360	75		
	空载转速 (rpm) NO LOAD SPEED	750	300	214	157	93	58	42	30	21	15	11	8	5	4	3	2		

电机参数/Motor data

型号 MODEL	额定电压 RATED VOLT V	空载 NO LOAD		最大效率 AT MAXIMUM EFFICIENCY					堵转	
		转速 SPEED r/min	电流 CURRENT A	转速 SPEED r/min	电流 CURRENT A	扭矩 TORQUE g. cm	输出功率 OUT PUT W	效率 EFF %	扭矩 TORQUE g. cm	电流 CURRENT A
DRC-775PH-124500	12	4500	0.44	3710	2.05	480	17.8	72	2706	10.2
DRC-775PH-243000	24	3000	0.21	2590	0.6	364	9.87	68	2050	3.2