

DFF-M20

Precious Metal-brush Motors

Output : Approx 0.05W-0.8W

Typical Applications : MD Player Car CD Player Camera
Camcorder Radio Control Model



∅10.1

Specifications

MODEL	VOLTAGE		NO LOAD		AT MAXIMUM EFFICIENCY					STALL		
	OPERATING RANGE	NOMINAL V	SPEED r/min	CURRENT A	SPEED r/min	CURRENT A	TORQUE g.cm	TORQUE mN.m	OUTPUT W	TORQUE g.cm	CURRENT A	
DFF-M20VA-8Z130	3.5V MAX	3.0	15200	0.045	11820	0.16	1.7	0.16	0.20	7.5	0.74	0.55
DFF-M20WA-7Z170	4.0V MAX	2.0	8000	0.025	5980	0.08	0.93	0.09	0.057	3.7	0.36	0.22

UNIT:MILLMETERS

DIRECTION OF ROTATION

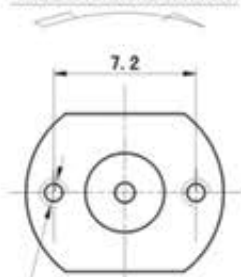

ISO M1.4X0.3 TAPPED HOLE
2 PLACES

Usable machine screw length 1.0 max.
form motor mounting surface.

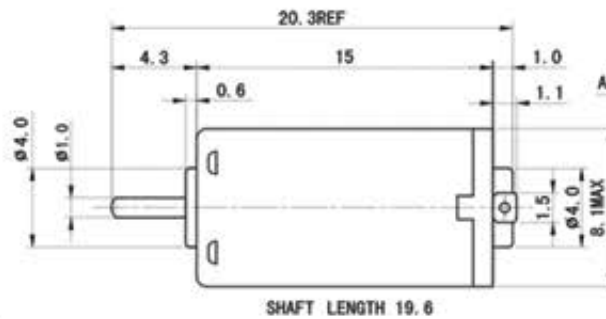

SHAFT LENGTH 19.6

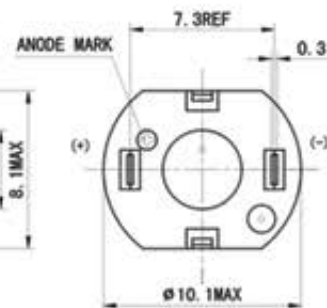

WEIGHT:4.0g (APPROX)

SFF-M20VA-8Z130

3.0V

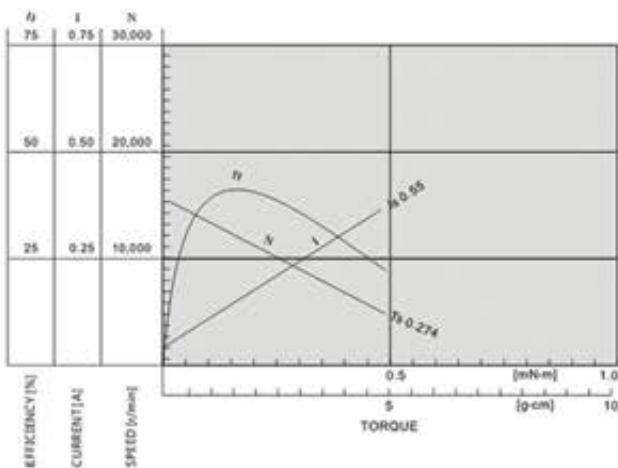

SFF-M20VA-7Z170

2.0V

