

DRC-545

主要用途: 打印机、家用电风扇

Typical Applications: Copy Machine
Household fan

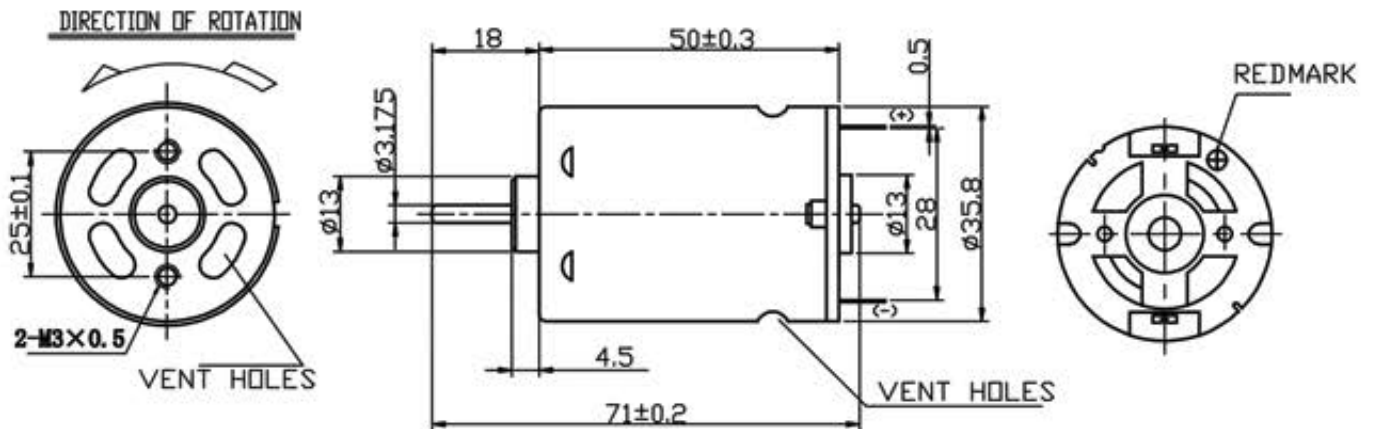

WEIGHT: 160g (APPROX)

UNIT: MM

型号 MODEL	电压 VOLTAGE		空载 NO LOAD		最大效率 AT MAXIMUM EFFICIENCY				堵转 STALL		
	使用范围 OPERATING RANGE	额定值 NOMINAL	转速 SPEED	电流 CURRENT	转速 SPEED	电流 CURRENT	扭矩 TORQUE	输出功率 OUT PUT	效率 EFF	扭矩 TORQUE	电流 CURRENT
	V	V	r/min	A	r/min	A	g. cm	W	%	g. cm	A
DRC-545SA-17165	9~15	12	2450	0.065	1974	0.257	84.86	1.72	55.8	447	1.08
DRC-545SH-21100	9~30	24	7850	0.15	6530	0.778	188	12.6	67.5	1120	3.9

